

SECTION X-X
INSULATION BARREL
SCALE 20:1

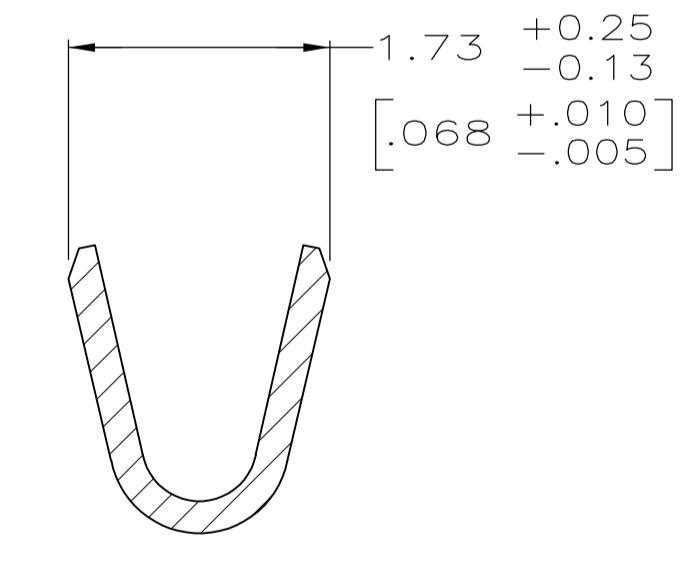

SECTION Y-Y
WIRE BARREL
SCALE 20:1

- 1 FOR MINI-APPLICATOR AND STRIPPER CRIMPER.
- 2 FOR HAND TOOL USE ONLY.
- 3. WIRE RANGE OF 20-24 AWG. INSULATION RANGE OF 1.27/1.52 [.050-.060].
- 4. GOLD PLATING MAY NOT APPEAR ON CARRIER STRIP.
- 5. GOLD PLATED IN LOCALIZED GOLD PLATE AREA AS FOLLOWS:
 0.76μm [.000030] MIN GOLD IN MATED AREA, 2.54μm [.000100] MIN TIN ON WIRE BARRELS, ALL OVER 1.27μm [.000050] MIN NICKEL UNDERPLATE.
 OR
 GOLD FLASH OVER PALLADIUM-NICKEL PLATE, 0.76μm [.000030] MIN TOTAL IN MATED AREA, 2.54μm [.000100] MIN TIN ON WIRE BARRELS, ALL OVER 1.27μm [.000050] MIN NICKEL UNDERPLATE.
- 6. GOLD FLASH IN LOCALIZED GOLD PLATE AREA, 2.54μm [.000100] MIN TIN PLATED WIRE BARRELS, ALL OVER 0.76μm [.000030] MIN NICKEL UNDERPLATE.
- 7. GOLD FLASH IN LOCALIZED GOLD PLATE AREA, 0.76μm [.000030] MIN TIN PLATED WIRE BARRELS, ALL OVER 0.76μm [.000030] MIN NICKEL UNDERPLATE.

1	1	STRIP	1658539-5
2	2	LOOSE PIECE	1658539-4
3	3	LOOSE PIECE	1658539-3
4	4	STRIP	1658539-2
5	5	STRIP	1658539-1
FINISH	USE	TYPE	PART NUMBER

THIS DRAWING IS A CONTROLLED DOCUMENT.

DIMENSIONS: mm [INCHES]	TOLERANCES UNLESS OTHERWISE SPECIFIED:	DIN R SAMICK 11AUG03	APVD M WALMSLEY 11AUG03	NAME M WALMSLEY	Tyco Electronics Corporation Harrisburg, PA 17105-3608
0 PLC ± -	1 PLC ± -	CHK S BOLASH 11AUG03	PRODUCT SPEC 108-40005	SIZE A1	RESTRICTED TO
2 PLC ± 0.13 [.005]	3 PLC ± -		APPLICATION SPEC 114-10000	SCALE 10:1	
4 PLC ± -	ANGLES ± -	MATERIAL BRASS	FINISH SEE TABLE	WEIGHT -	100779 C=1658539
CUSTOMER DRAWING			SCALE 10:1	SHEET 1 OF 1	REV C